

Taburaum Zylinder

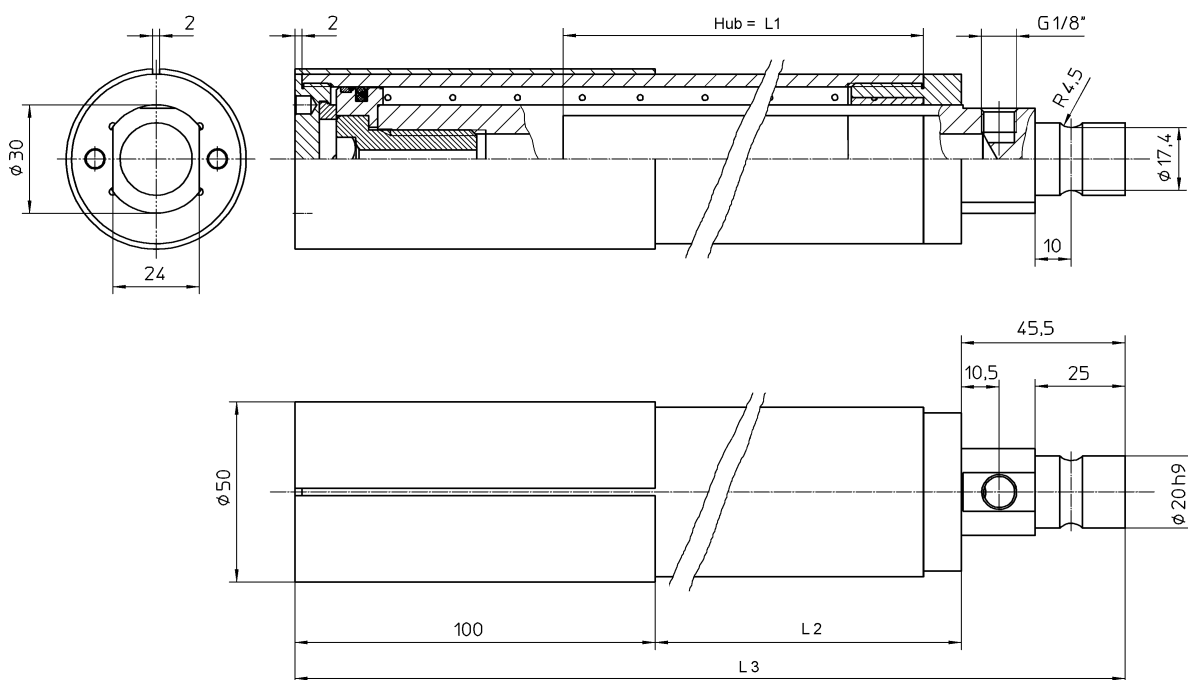
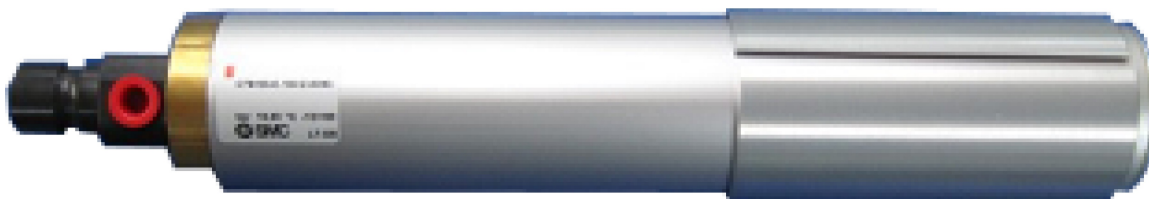

| SMC Bestellbezeichnung | Hubabhängige Maße | | |
|------------------------|-------------------|-----|-------|
| | L1 | L2 | L3 |
| C76KE40-100/Z-5307 | 100 | 85 | 230,5 |
| C76KE40-125/Z-5307 | 125 | 110 | 255,5 |
| C76KE40-150/Z-5307 | 150 | 145 | 290,5 |
| C76KE40-175/Z-5307 | 175 | 170 | 315,5 |
| C76KE40-200/Z-5307 | 200 | 195 | 340,5 |
| C76KE40-225/Z-5307 | 225 | 225 | 370,5 |